

CC1300XL Small Walk Behind Saw



Gasoline



Electric



Hydraulic



Propane
Option

14" - 20" Blade Capacity

Push Drive

Features & Benefits

- Heavy duty frame design
- Cyclone air filter (Honda models)
- Four position heavy duty handles offer no slack and don't rattle like other adjustable handles
- Through rear axle for added strength
- Solid sealed and self aligning blade shaft bearings
- Slip-on blade guard for easy blade access
- Three V-belts for extra power delivery to the blade shaft
- Left or right side sawing
- Optional water tank available for dust suppression

Specifications

Maximum depth of cut with 14" blade:	4-5/8"
Maximum depth of cut with 18" blade:	6-5/8"
Maximum depth of cut with 20" blade:	7-5/8"
Blade shaft RPM:	2,600
Blade shaft diameter:	1-1/4"
Arbor size:	1" with single drive pin
Blade mounting:	Right or left
Blade raise/lower:	Precision screw feed
Handle bars:	Adjustable



Shown with optional water tank & bracket kit

CC1311HXL-20
blade not included

Electric Models are Suitable
Where Exhaust Fumes
are Not Allowed



CC1310E3XL-20
blade not included



Heavy duty adjustable handles and
precision screw feed raise and lower

Horsepower and Torque as rated
by the engine manufacturer.

Sawing

190

CORE
CUT

Parts List # (Gas): 1801801
Parts List # (Electric): 1801809
Operator Manual #: 1801459

CC1300XL SMALL WALK BEHIND SAW

Saw Model #	Engine/Motor Make	Engine/Motor Model	Engine/Motor Power	Power Source	Blade Capacity	Part #	Cat #	Product Weight (lbs)	List Price
CC1308HXL-14	Honda	GX270	8.5 HP, 14.1 Torque (lbs.-ft.)	Gas	14"	5800575	75066	225	3,433
CC1311HXL-14	Honda	GX390	11.7 HP, 19.5 Torque (lbs.-ft.)	Gas	14"	5800576	75067	260	3,584
CC1313BXL-14	Briggs \diamond	2100	420cc, 21 Torque (lbs.-ft.)	Gas	14"	5801117	61491	265	2,868
CC1305E1XL-14	Baldor	n/a	5 HP, 230V - 1PH	Electric	14"	5800577	75068	240	3,942
CC1305E3XL-14	Baldor	n/a	5 HP, 230V - 3PH	Electric	14"	5800578A	99977	245	4,116
CC1305E3XL-14	Baldor	n/a	5 HP, 480V - 3PH	Electric	14"	5800578B	26493	245	4,116
CC1311HUXL-14	Honda	GX390 upcut	11.7 HP, 19.5 Torque (lbs.-ft.)	Gas	14"	5800871	27131	350	4,139
CC1313BUXL-14	Briggs \diamond	2100 upcut	420cc, 21 Torque (lbs.-ft.)	Gas	14"	5801118	61493	355	3,310
CC1308HXL-18	Honda	GX270	8.5 HP, 14.1 Torque (lbs.-ft.)	Gas	18"	5800579	75070	225	3,501
CC1311HXL-18	Honda	GX390	11.7 HP, 19.5 Torque (lbs.-ft.)	Gas	18"	5800571	69995	260	3,663
CC1313BXL-18	Briggs \diamond	2100	420cc, 21 Torque (lbs.-ft.)	Gas	18"	5801116	61494	265	2,930
CC1305E1XL-18	Baldor	n/a	5 HP, 230V - 1PH	Electric	18"	5800580	75071	280	3,984
CC1305E3XL-18	Baldor	n/a	5 HP, 230V - 3PH	Electric	18"	5800581A	93652	245	4,165
CC1305E3XL-18	Baldor	n/a	5 HP, 480V - 3PH	Electric	18"	5800581B	97080	245	4,165
CC1311HUXL-18	Honda	GX390 upcut	11.7 HP, 19.5 Torque (lbs.-ft.)	Gas	18"	5800872	26751	350	4,202
CC1313BUXL-18	Briggs \diamond	2100 upcut	420cc, 21 Torque (lbs.-ft.)	Gas	18"	5801119	61496	355	3,362
CC1310E3XL-20	Baldor*	n/a	10 HP, 230V - 3PH	Electric	20"	5800589A	93810	315	5,770
CC1310E3XL-20	Baldor*	n/a	10 HP, 460V - 3PH	Electric	20"	5800589B	93220	340	5,770
CC1310E3XL-20	Baldor*	n/a	10 HP, 230V/460V - 3PH	Electric	20"	5800985	57763	335	6,724
CC1311HXL-20	Honda	GX390	11.7 HP, 19.5 Torque (lbs.-ft.)	Gas	20"	5800723	21855	365	3,715
CC1313HYXL-20	Danfoss	n/a	13HP, 15 GPM	Hydraulic	20"	5800724A	37387	230	5,228
CC1313HYXL-20	Danfoss	n/a	13HP, 20 GPM	Hydraulic	20"	5800724B	50852	230	5,228
CC1313HYXL-20	Danfoss	n/a	13HP, 25 GPM	Hydraulic	20"	5800724C	37388	230	5,228

\diamond Briggs 2100 Series models include a Diamond Products 3-year extended warranty

* Right hand sawing only models

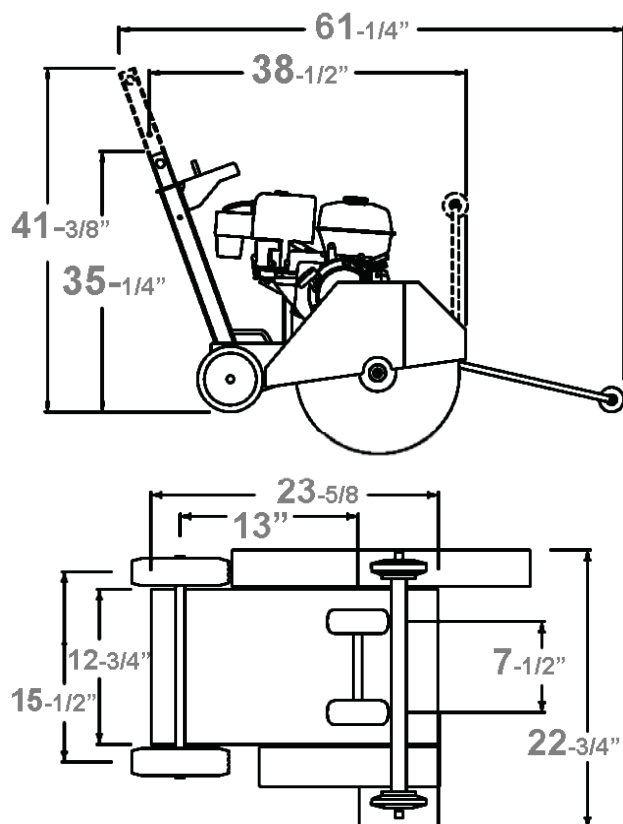

CC1300XL OPTIONS

Description	Part #	Cat #	List Price
Water Tank Kit with 5/8" hose (5 gal.)** - includes water tank bracket	6049050	36252	\$208
Extended Blade Shaft Kit (up to 1" spacing)	6048107	48388	48
Catalytic Muffler for 11HP Honda	2501567	78637	1,061
Propane Conversion Kit for 8.5 HP Honda (4.7 gallon tank, horizontal vapor)+ [must also order with Part # 6048940]	6040321	10155	2,818
Propane Conversion Kit for 11.7 HP Honda (4.7 gallon tank, horizontal vapor)+ [must also order with Part # 6048940]	6040322	10156	2,818
Extra Slip-on Blade Guard 14"	6048912	97088	449
Extra Slip-on Blade Guard 18"	6048910	97883	490
Extra Slip-on Blade Guard 20"	6048904	98682	609

** For dust suppression when dry cutting.

Water tank kit not available for electric saw models.

+ Propane conversion kits include the following: conversion to dual fuel, safety fuel lock, liquid propane fuel tanks with float gauge and safety check connector.

Sawing